



*"Simply Better"*

SKIRTEC GROUP PTY LTD  
ABN 77 074 107 805  
Head Office Contact:  
TEL 07 3375 6144  
FAX 07 3375 6033  
Email sales@skirtec.com.au

**FREECALL 1800 064 435**

# ABD10050 BENCH DUCT

2 Channel Extruded Aluminium Bench Duct

INTRODUCING

ANOTHER

*"Simply Better"*

ECONOMICAL  
BENCH DUCT  
PRODUCT

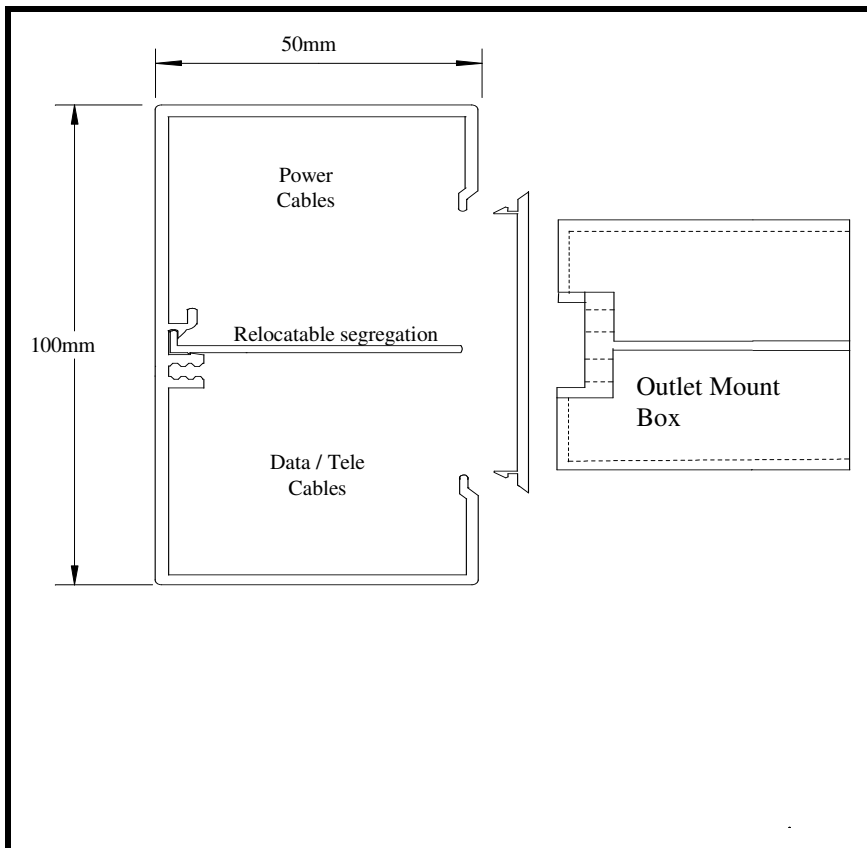

- \* NEW ALUMINIUM BENCH DUCT
- \* STILL THE EASIEST DUCT TO INSTALL
- \* OUTLET KITS DO NOT NEED COVER

## DIMENSIONS

Profile: 100mm X 50mm  
Lengths: Base 3 metres  
Cover 3 metres

Indicative cable and outlet capacity (with mounts in):

- up to 30 data/tele. & up to 8 power cables.
- up to 8 outlets per metre of duct
- \* Outlet kits to suit 84 mm mounting centres.

CAT No	Description
ABD10050	Aluminium bench duct c/w cover 3M
ABD-10050-MT	Outlet kit for standard grid plate* data or GPO
ABD-50ES	End Stop for bench duct
SET UP	Powdercoat set up fee for Special Colours
Colours	Stock colours, clear anodised, grey, white birch

## SUGGESTED SPECIFICATIONS

The Contractor shall install a 2 Channel Bench Duct, SKIRTEC ABD10050, as indicated on the tender drawings.

Outlets shall be of standard grid plate size and mounted in the centre of the duct with no visible cover joints adjacent. The duct shall be powdercoated or anodised.

COLOURS AVAILABLE, CLEAR ANODISED, WHITE BIRCH AND GREY.  
OTHER POWDER COAT COLOURS AVAILABLE UPON REQUEST.